

DIAGRAMS & PARTS LIST



6W400009-1

IK-12max3 TORCH L-100

DIAGRAM

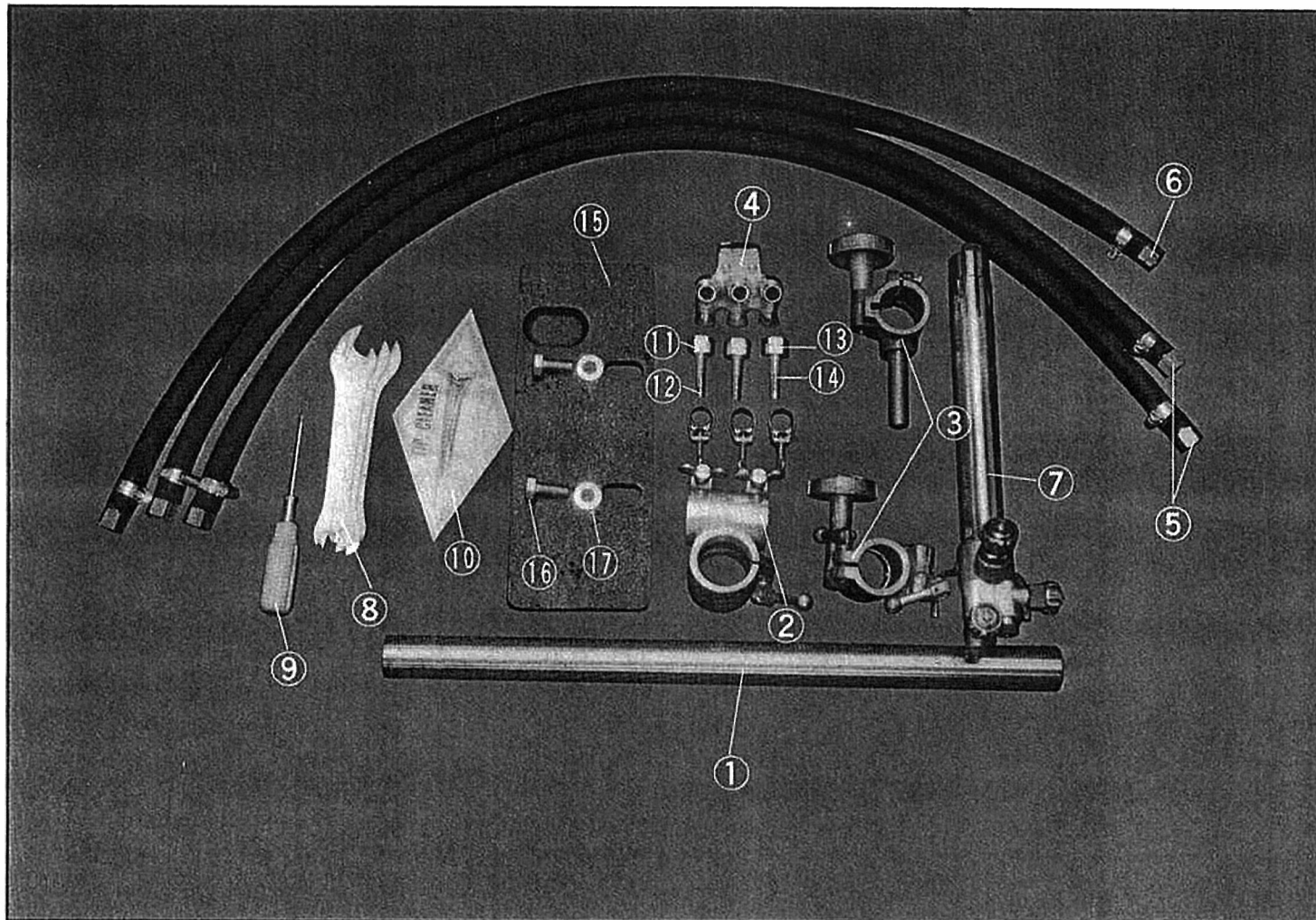

PARTS LIST

ITEM No.	PART NAME	Qty	STOCK No.	REMARKS
1	Pipe arm	1	60030321	500mm
2	Arm holder unit	1	60030301	
3	Torch holder assembly	1	60030367	
4	Distributor	1	60013301	Except U.S.A.
	Distributor	1	60013302	U.S.A. only
5	Hose for oxygen	2	60030368	Except U.S.A.
	Hose for oxygen		60030369	U.S.A. only
6	Hose for gas	1	60030370	Except U.S.A.
	Hose for gas		60030371	U.S.A. only
7	Torch	1	60010701	Except U.S.A.
	Torch		60010702	U.S.A. only

ITEM No.	PART NAME	Qty	STOCK No.	REMARKS
8	Spanner	1	60030309	
9	Screw driver	1	60030310	
10	Tip cleaner	1	60030311	
11	Nut for oxygen	2	60015001	Except U.S.A. M16×P1.5
12	Hose connector	2	60015003	Except U.S.A. 5/16
13	Nut for gas	1	60015002	Except U.S.A. M16×P1.5 Right
14	Hose connector	1	60015004	3/8
15	Weight	1	60030346	
16	Hex bolt	2	6C011035	BH-10×35
17	Washer	2	6D500100	WF-10



6W400009-1

IK-12max3 TORCH L-100

DIAGRAM

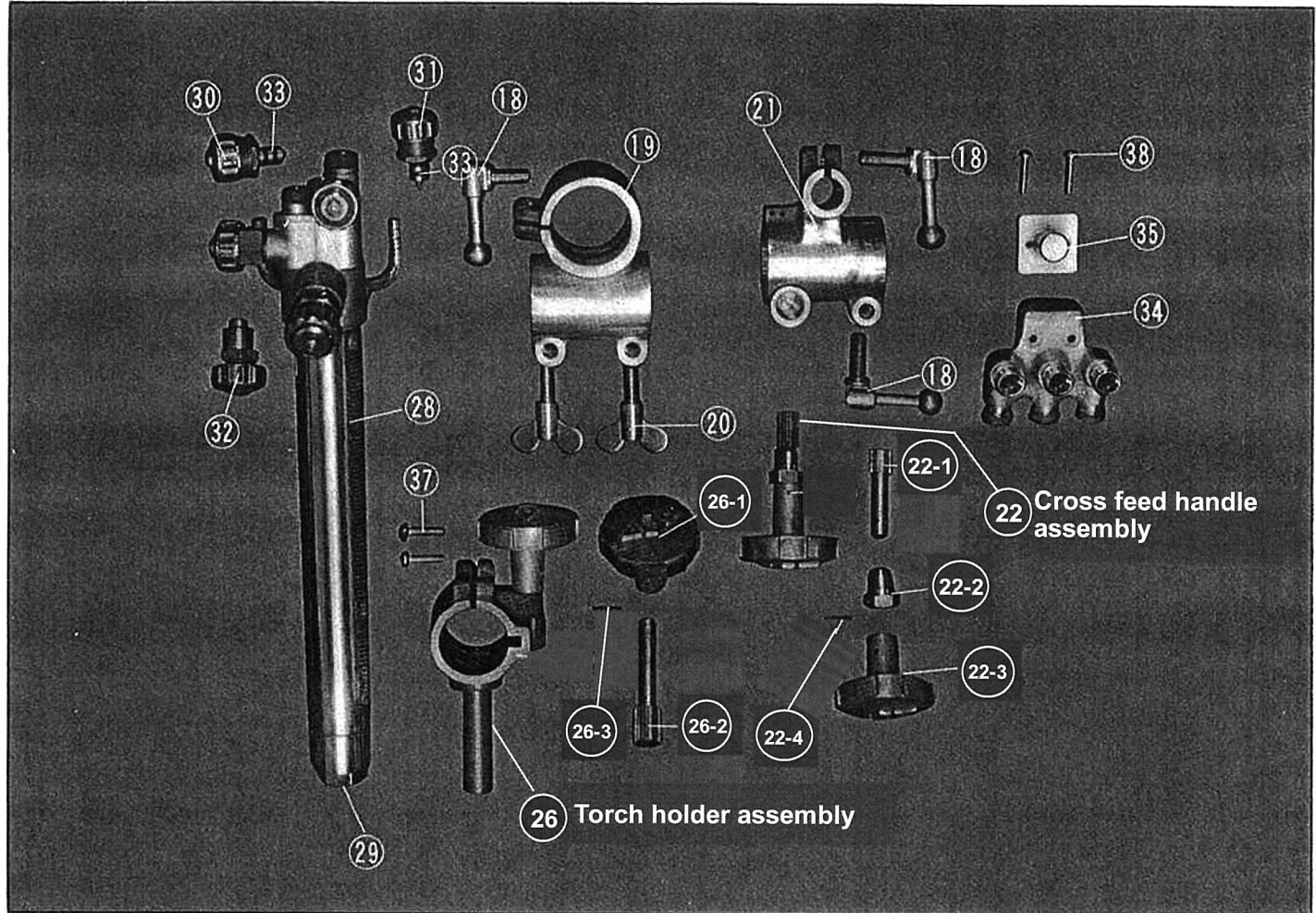

PARTS RIST

ITEM No.	PART NAME	Qty	STOCK No.	REMARKS
18	Crank handle	1	60030313	
19	Arm holder base	1	60030314	
20	Wing bolt	3	60030315	
21	Cross feed holder	1	60030372	With key
22	Cross feed handle assembly	1	60030373	
22-1	Pinion	1	60030375	
22-2	Pinion metal	1	60030374	
22-3	Handle	1	60030317	
22-4	Spring pin	1	6B022516	PR-2.5×16
26	Torch holder assembly	1	60030376	
26-1	Handle	1	60030317	
26-2	Pinion	1	60030377	

ITEM No.	PART NAME	Qty	STOCK No.	REMARKS
26-3	Spring pin	1	6B022516	PR-2.5×16
28	Torch rack	1	60010703	With screw
29	Tip fixing nut	1	60005020	
30	Valve for preheat oxygen	1	60015355	★
31	Valve for gas	1	60015356	★
32	Valve for jet oxygen	1	60015122	
33	O-Ring	1	60005026	
34	Distributor body	1	60013303	
	Distributor body	1	60013304	U.S.A. only
35	Distributor bracket	1	60013305	
37	Screw	2	6C520418	SP-4×18
38	Screw	2	6C520430	SP-4×30



IK-12max3
TORCH L-100 PARTS LIST

Date of issue: Feb.2012
2nd Jan.2013

KOIKE SANZO KOGYO CO.,LTD.
Printed in Japan