

DIAGRAMS & PARTS LIST



IK-12max3

6W400003

TORCH S-100

DIAGRAM

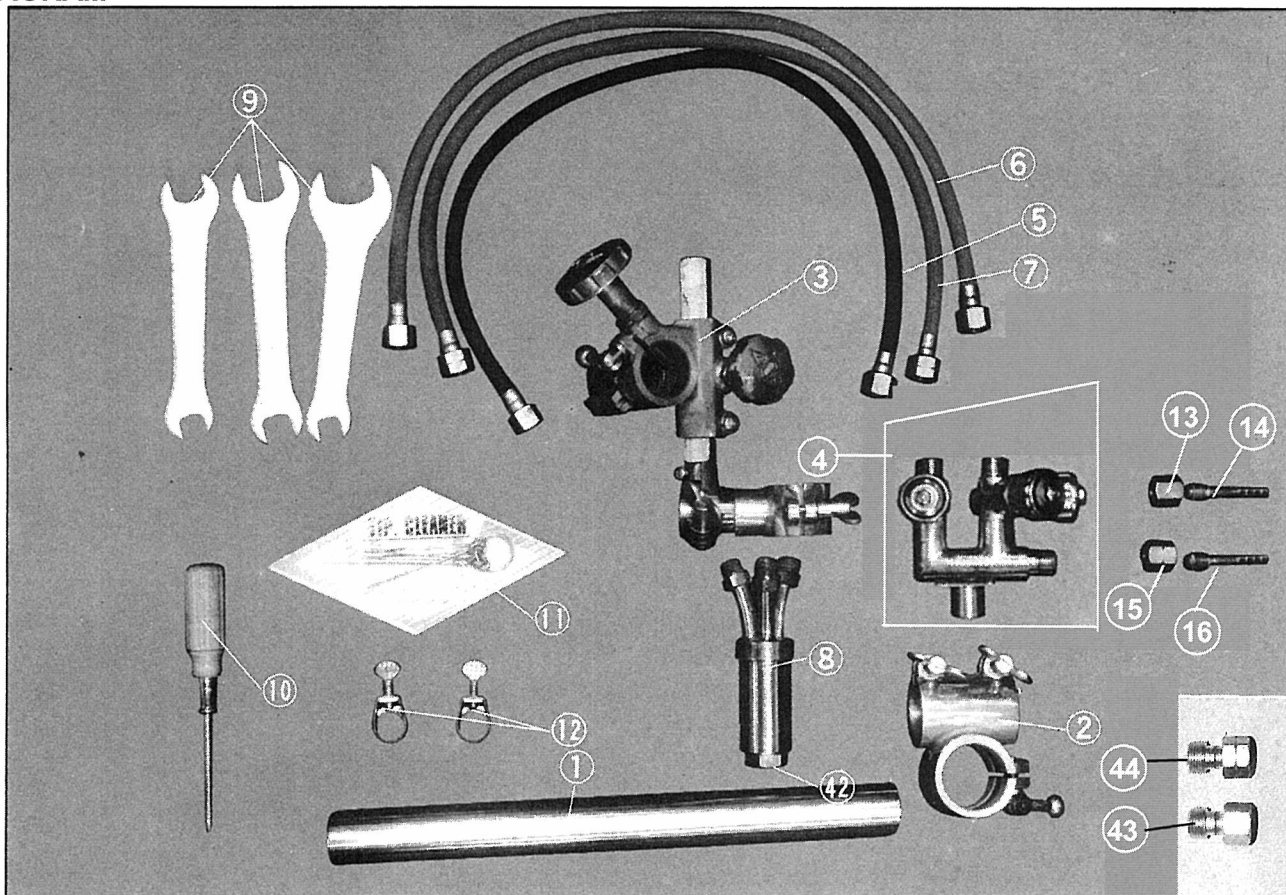

PARTS RIST

| ITEM No. | PART NAME | Qty | STOCK No. | REMARKS |
|----------|-------------------------|-----|-----------|----------------|
| 1 | Pipe arm | 1 | 60030300 | Standard 350mm |
| 2 | Bar holder assembly | 1 | 60030301 | |
| 3 | Torch holder (B Type) | 1 | 60030302 | |
| 4 | Distributor assembly | 1 | 60013201 | Except USA KE |
| | | | 60013202 | USA only |
| | | | 60013205 | KE only |
| 5 | Hose for jet oxygen | 1 | 60030303 | Except USA KE |
| | | | 60030304 | USA only |
| | | | 60030305 | KE only |
| 6 | Hose for preheat oxygen | 1 | 60030305 | Except USA |
| | | | 60030306 | USA only |
| 7 | Hose for gas | 1 | 60030307 | Except USA |
| | | | 60030308 | USA only |
| 8 | Torch | 1 | 60010601 | Except USA KE |
| | | | 60010602 | USA only |
| | | | 60010606 | KE only |

| ITEM No. | PART NAME | Qty | STOCK No. | REMARKS |
|----------|---------------------------|-----|-----------|----------------------------|
| 9 | Spanner | 1 | 60030309 | |
| 10 | Screw driver | 1 | 60030310 | |
| 11 | Tip cleaner | 1 | 60030311 | |
| 12 | Hose band | 2 | 60030312 | Except USA |
| 13 | Nut for oxygen | 1 | 60015001 | Except USA KE M16 P1.5 |
| | | | 60015056 | KE only |
| 14 | Hose connector for oxygen | 1 | 60015003 | Except USA KE 5/16 |
| | | | 60015040 | KE only |
| 15 | Nut for gas | 1 | 60015002 | Except USA KE M16 P1.5Left |
| | | | 60015054 | KE only |
| 16 | Hose connector for gas | 1 | 60015004 | Except USA KE. 3/8 |
| | | | 60015062 | KE only |
| 43 | Hose joint | 1 | 60012917 | KE only |
| 44 | Hose joint | 1 | 60012904 | KE only |



KOIKE SANZO KOGYO CO., LTD



IK-12max3 TORCH S-100

DIAGRAM

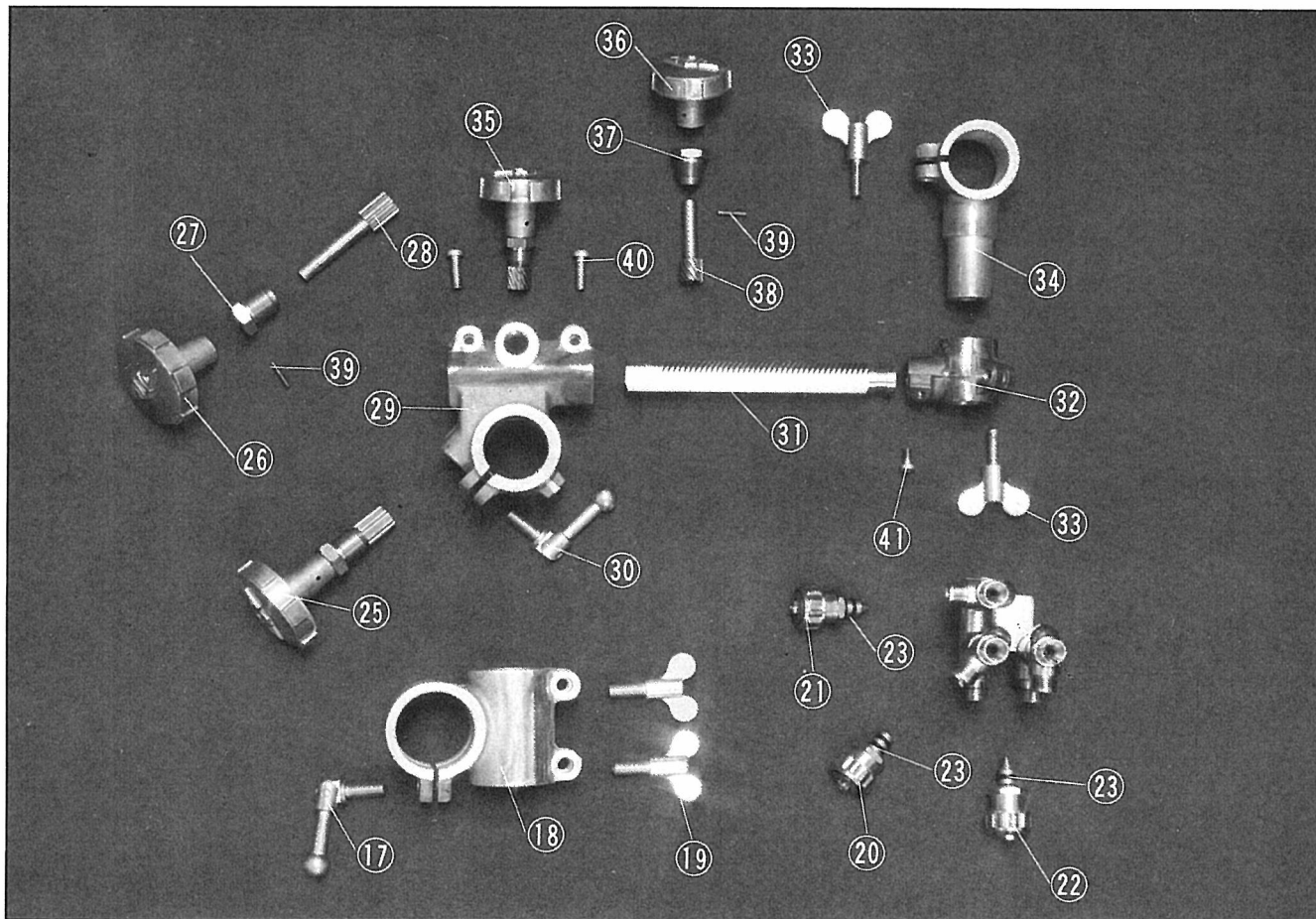

PARTS RIST

| TEM No. | PART NAME | Qty | STOCK No. | REMARKS |
|---------|----------------------------|-----|-----------|----------|
| 17 | Crank handle | 1 | 60030313 | M8 |
| 18 | Arm holder | 1 | 60030314 | |
| 19 | Wing bolt | 2 | 60030315 | M8 |
| 20 | Valve for jet oxygen | 1 | 60015251 | |
| 21 | Valve for preheat oxygen | 1 | 60015255 | |
| 22 | Valve for gas | 1 | 60015256 | |
| 23 | O-Ring | | 60005026 | KS-5 |
| 25 | Cross feed handle assembly | 1 | 60030316 | |
| 26 | Handle | 1 | 60030317 | φ 50 |
| 27 | Pinion metal | 1 | 60030318 | |
| 28 | pinion | 1 | 60030319 | |
| 29 | Cross feed unit | 1 | 60030320 | With key |
| 30 | Crank handle | 1 | 60030313 | |

| ITEM No. | PART NAME | Qty | STOCK No. | REMARKS |
|----------|-------------------------|-----|-----------|-----------|
| 31 | Slide bar | 1 | 60030390 | |
| 32 | Torch holder bracket | 1 | 60030391 | |
| 33 | Wing bolt | 2 | 60030392 | |
| 34 | Torch holder | 1 | 60030393 | |
| 35 | Up/down handle assembly | 1 | 60030394 | |
| 36 | Handle | 1 | 60030223 | |
| 37 | Pinion metal | 1 | 60030395 | |
| 38 | Pinion | 1 | 60030396 | |
| 39 | Spring pin | 2 | 6B022516 | PR-2.5×16 |
| 40 | Screw | 2 | 6C520618 | SP-6×18 |
| 41 | Screw | 1 | 6C520510 | SP-5×10 |
| 42 | Tip fixing nut | 1 | 60005020 | |



IK-12max3

TORCH S-100 PARTS LIST

KOIKE SANZO KOGYO CO.,LTD.

Date of issue : May.2012 Printed in Japan