

IK-12max3 TORCH S-200

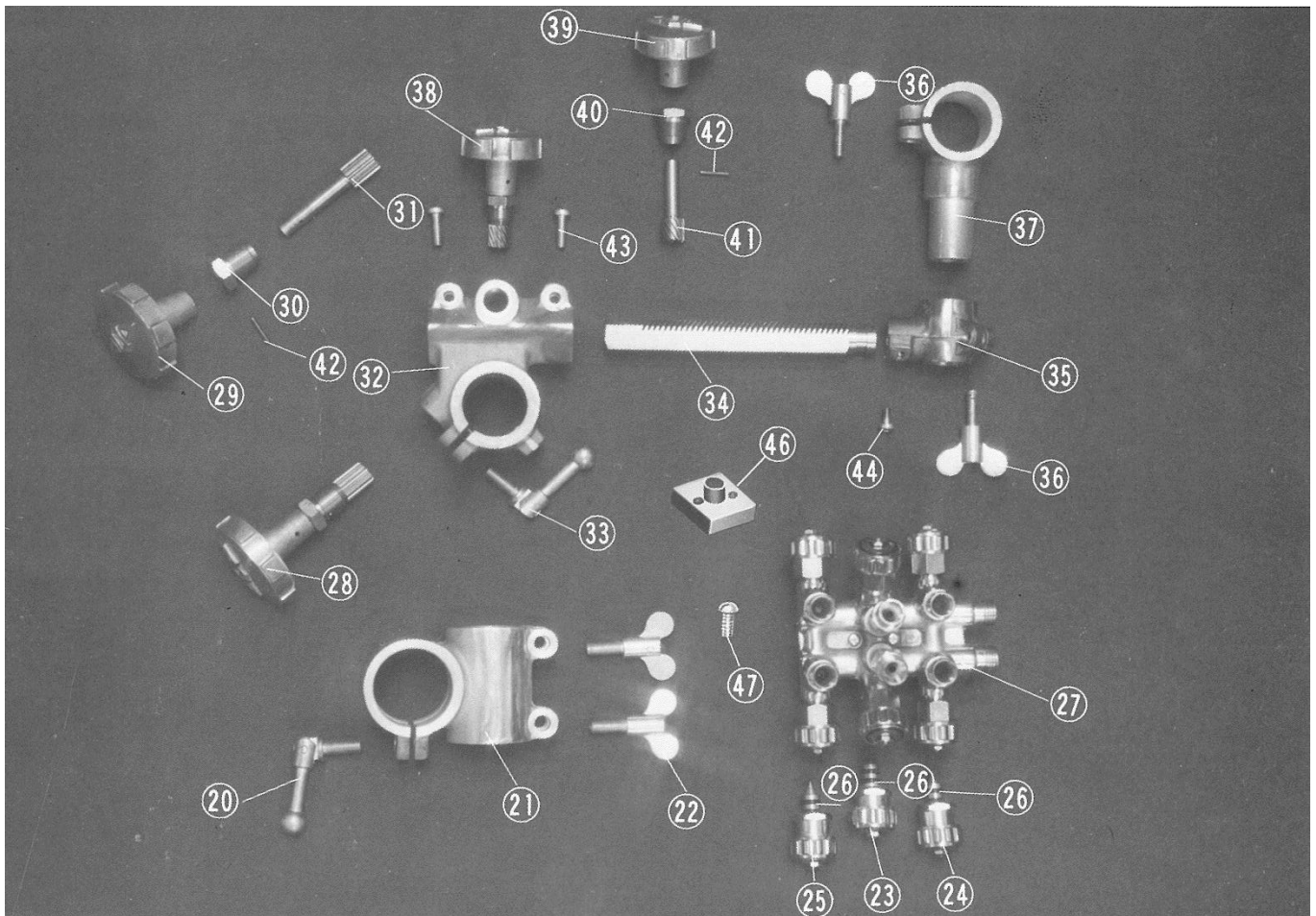

ITEM No.	PART NAME	Qty	STOCK No.	REMARKS
20	Crank handle	1	60030313	M8
21	Bar holder	1	60030314	
22	Wing bolt	2	60030315	
23	Valve for jet oxygen	2	60015251	
24	Valve for preheat oxygen	2	60015255	
25	Valve for gas	2	60015256	
26	O-Ring	6	60005026	
28	Cross feed assembly	1	60030316	
29	Handle	1	60030317	φ 50
30	Pinion metal	1	60030318	
31	pinion	1	60030319	
32	Cross feed unit	1	60030320	With key
33	Crank handle	1	60030313	
34	Slide bar	1	60030390	

ITEM No.	PART NAME	Qty	STOCK No.	REMARKS
35	Torch holder bracket	1	60030391	
36	Wing bolt	2	60030392	
37	Torch holder	1	60030393	
38	Up/down handle assembly	1	60030394	
39	Handle	1	60030223	
40	Pinion metal	1	60030395	
41	Pinion	1	60030396	
42	Spring pin	2	6B022516	PR-2.5x16
43	Screw	2	6C520618	SP-6x18
44	Screw	1	6C520510	SP-5x10
45	Tip fixing nut	1	60005020	
46	Distributor bracket	1	60013305	
47	Screw	2	6C520420	SP-4x20

IK-12max3 TORCH S-200

Date of issue: May.2019

KOIKE SANZO KOGYO CO., LTD