

# IK-12max3 TORCH SP-100

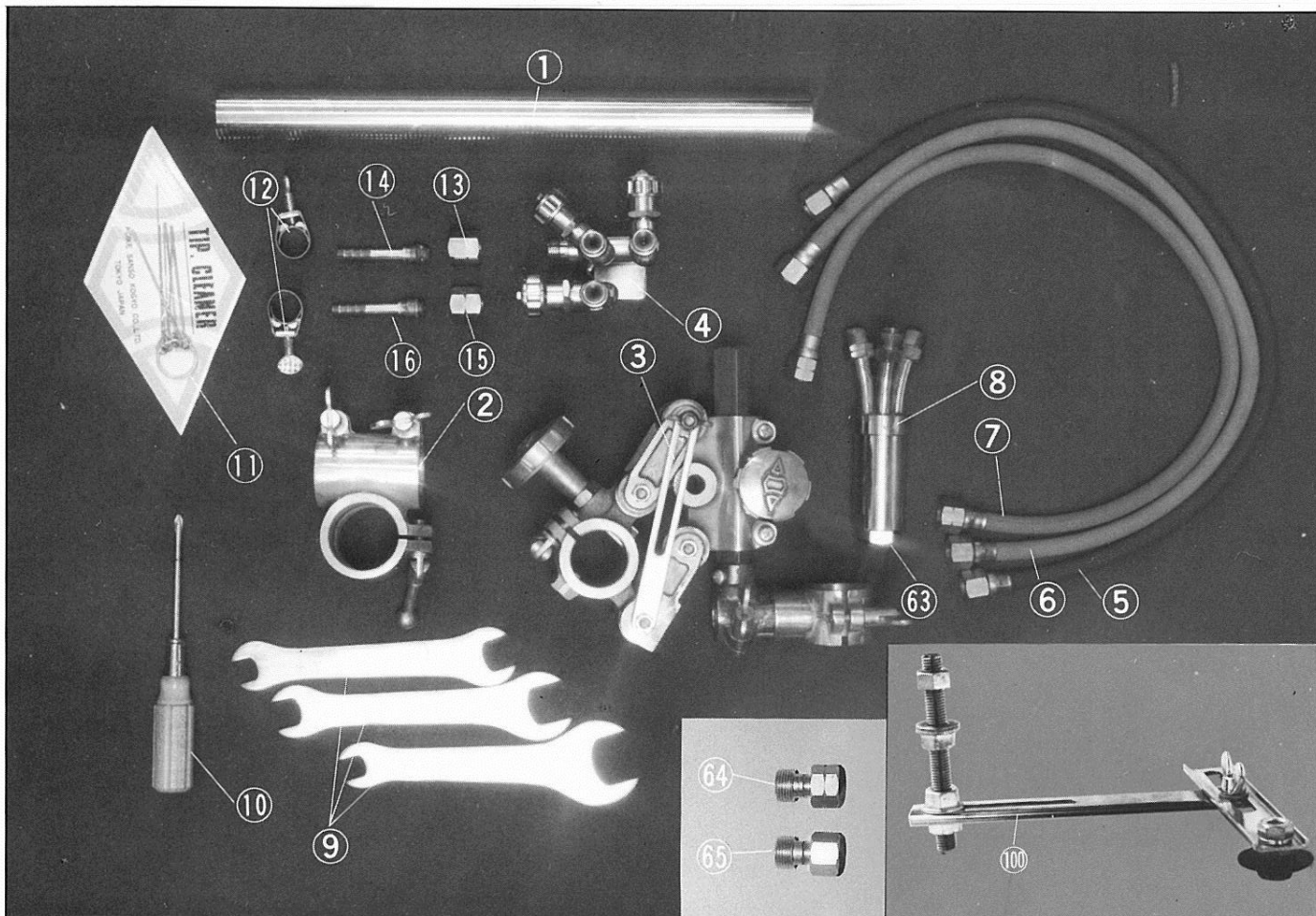

BCD24B00



ITEM No.	PART NAME	Qty	STOCK No.	REMARKS
1	Pipe arm	1	60030300	Standard 350mm
2	Bar holder	1	60030301	
3	Torch holder (A Type)	1	60030328	
4	Distributor	1	60013201	Except USA,KE
	Distributor	(1)	60013202	USA only
	Distributor	(1)	60013205	KE only
5	Hose for jet oxygen	1	60030303	Except USA ,KE
	Hose for jet oxygen	(1)	60030304	USA only
	Hose for jet oxygen	(1)	60030305	KE only
6	Hose for preheat oxygen	1	60030305	Except USA
	Hose for preheat oxygen	(1)	60030306	USA only
7	Hose for gas	1	60030307	Except USA
	Hose for gas	(1)	60030308	USA only
8	Torch	1	60010601	Except USA,KE
	Torch	(1)	60010602	USA only
	Torch	(1)	60010606	KE only

ITEM No.	PART NAME	Qty	STOCK No.	REMARKS
9	Spanner	1	60030309	
10	Screw driver	1	60030310	
11	Tip cleaner	1	60030311	
12	Hose band	2	60030312	Except USA
13	Nut for oxygen	1		It varies by country
14	Hose connector for oxygen	1		It varies by country
15	Nut for gas	1		It varies by country
16	Hose connector for gas	1		It varies by country
64	Hose joint	1		It varies by country
65	Hose joint	1		It varies by country

# IK-12max3 TORCH SP-100

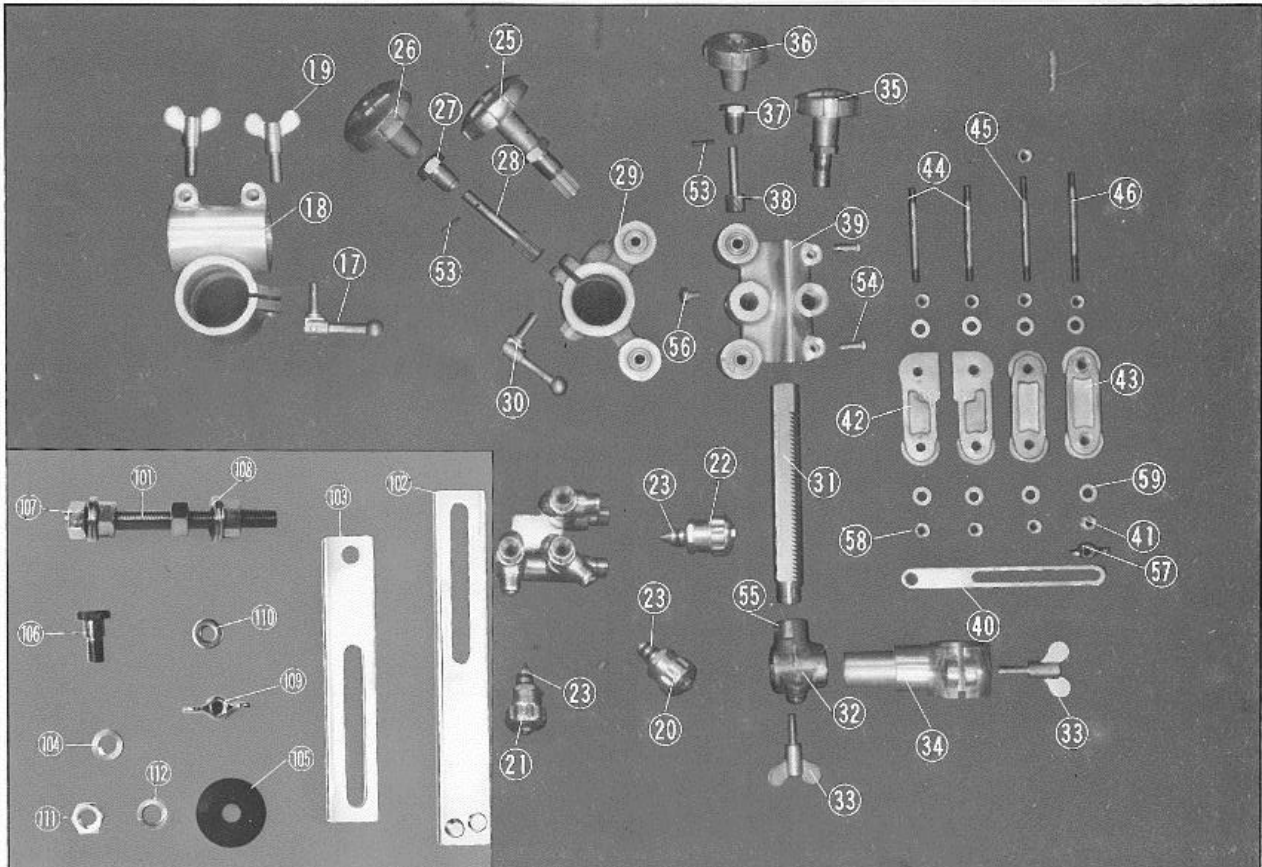

ITEM No.	PART NAME	Qty	STOCK No.	REMARKS
17	Crank handle	1	60030313	
18	Bar holder	1	60030314	
19	Wing bolt	2	60030315	
20	Valve for jet oxygen	1	60015251	
21	Valve for preheat oxygen	1	60015255	
22	Valve for gas	1	60015256	
23	O-ring	3	60005026	
25	Cross feed handle assembly	1	60030316	
26	handle	1	60030317	
27	Pinion metal	1	60030318	
28	Pinion	1	60030319	
29	Cross feed holder	1	60030329	
30	Crank handle	1	60030313	
31	Slide bar	1	60030390	
32	Torch holder base	1	60030391	
33	Wing bolt	2	60030392	
34	Torch holder	1	60030393	
35	Up/down handle assembly	1	60030394	
36	Handle	1	60030223	
37	Pinion metal	1	60030395	
38	Pinion	1	60030396	
39	Up/down holder assembly	1	60030330	
40	Set plate	1	60030331	
41	Nut	1	60030332	
42	Link arm(A)	2	60030333	
43	Link arm(B)	2	60030334	
44	Bearing shaft(A)	2	60030335	

ITEM No.	PART NAME	Qty	STOCK No.	REMARKS
45	Bearing shaft(B)	1	60030336	
46	Bearing shaft(C)	1	60030337	
53	Spring pin	2	6B022516	PR-2.5x16
54	Screw	2	6C120625	SP-6x18
55	Screw	1	6C520510	SP-5x10
56	Hex bolt	1	6C010612	BH-6x12
57	Wing nut	1	6D090060	NB-6
58	Hex nut	8	6D010060	NH-6
59	Washer	8	6D500060	WF-6
63	Tip fixing nut	1	60005020	
100	Guide roller ass'y	1	60032340	
101	Setting shaft	1	60032341	
102	Plate A	1	60032342	
103	Plate B	1	60032345	
104	Collar	1	60032346	
105	Guide roller	1	60030342	
106	Guide roller shaft	1	60030343	
107	Hex, nut	4	6D010120	NH-12
108	Washer	4	6D500120	WF-12
109	Wing nut	1	6D090080	NB-8
110	Washer	1	6D500080	WF-8
111	Hex, nut	1	6D010100	NH-10
112	Spring washer	1	6D510100	WS-10

## IK-12max3 TORCH SP-100

Date of issue: May.2019

KOIKE SANSO KOGYO CO., LTD