

IK-12max3 TORCH SP-300

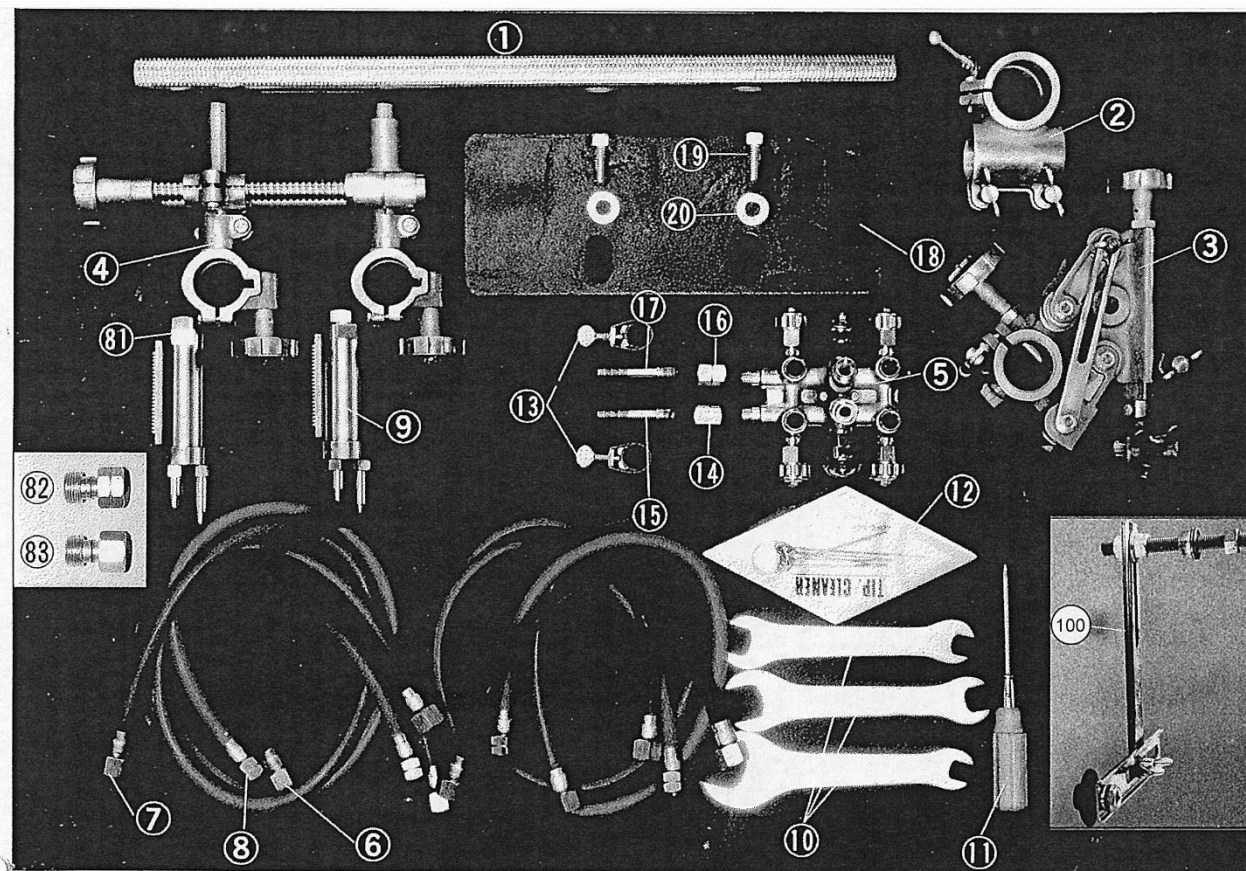

BCD18B00



ITEM No.	PART NAME	Qty	STOCK No.	REMARKS
1	Pipe arm	1	60030321	Standard 500mm
2	Arm holder	1	60030301	
3	Torch holder (C type)	1	60030344	
4	V-cutter holder	1	60030345	
5	Distributor	1	60013251	Except USA
	Distributor	(1)	60013252	USA only
	Distributor	(1)	60013256	KE only
6	Hose for jet oxygen	2	60030324	Except USA
	Hose for jet oxygen	(2)	60030323	USA only
7	Hose for preheat oxygen	2	60030324	Except USA
	Hose for preheat oxygen	(2)	60030325	USA only
8	Hose for gas	2	60030326	Except USA
	Hose for gas	(2)	60030327	USA only
9	Torch	2	60010651	Except USA
	Torch	(2)	60010652	USA only

ITEM No.	PART NAME	Qty	STOCK No.	REMARKS
10	Spanner	1	60030309	
11	Screw driver	1	60030310	
12	Tip cleaner	1	60030311	
13	Hose band	2	60030312	Except USA
14	Nut for oxygen	1		It varies by country
15	Hose connector for oxygen	1		It varies by country
16	Nut for gas	1		It varies by country
17	Hose connector for gas	1		It varies by country
18	Weight	1	60030346	
19	Hex bolt	2	6C011035	BH-10x35
20	Washer	2	6D500100	WF-10
82	Hose joint	1		It varies by country
83	Hose joint	1		It varies by country
100	Guide roller ass'y	1	60032340	

IK-12max3 TORCH SP-300



BCD18B00

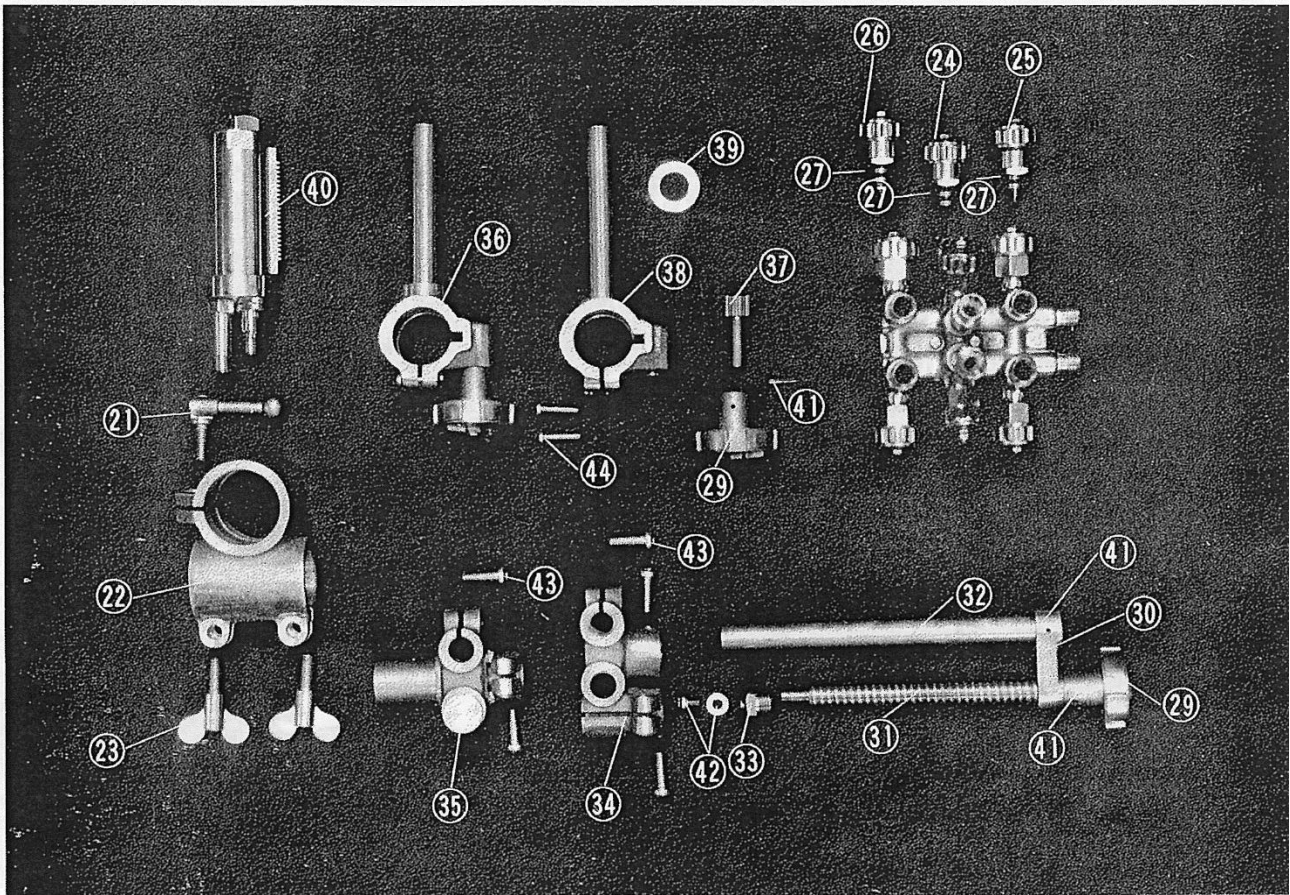

ITEM No.	PART NAME	Qty	STOCK No.	REMARKS
21	Crank handle	1	60030313	
22	Bar holder	1	60030314	
23	Wing bolt	2	60030315	
24	Valve for jet oxygen	2	60015251	Except KE
	Valve for jet oxygen	(2)	60015252	KE only
25	Valve for preheat oxygen	2	60015255	Except KE
	Valve for preheat oxygen	(2)	60015258	KE only
26	Valve for gas	2	60015256	
27	O-ring	6	60005026	
28	Distributor body	1	60013253	Except USA
	Distributor body	(1)	60013254	USA only
29	Handle	2	60030223	
30	Screw metal	1	60030347	
31	Screw	1	60030348	

ITEM No.	PART NAME	Qty	STOCK No.	REMARKS
32	Guide bar	1	60030349	
33	Bush	1	60030350	
34	Torch slide base	1	60030351	
35	Torch holder bracket	1	60030352	
36	Torch holder assembly	2	60030353	
37	Pinion	2	60030354	
38	Torch holder	2	60030355	
39	Graduation collar	2	60030356	With screw
40	Torch rack	2	60010653	With screw
41	Spring pin	4	6B022516	PR-2.5x16
42	Screw	1	6C520508	SP-5x8
43	Screw	5	6C520618	SP-6x18
44	Screw	4	6C610418	SP-4x18

K-12max3 TORCH SP-300



BCD18B00

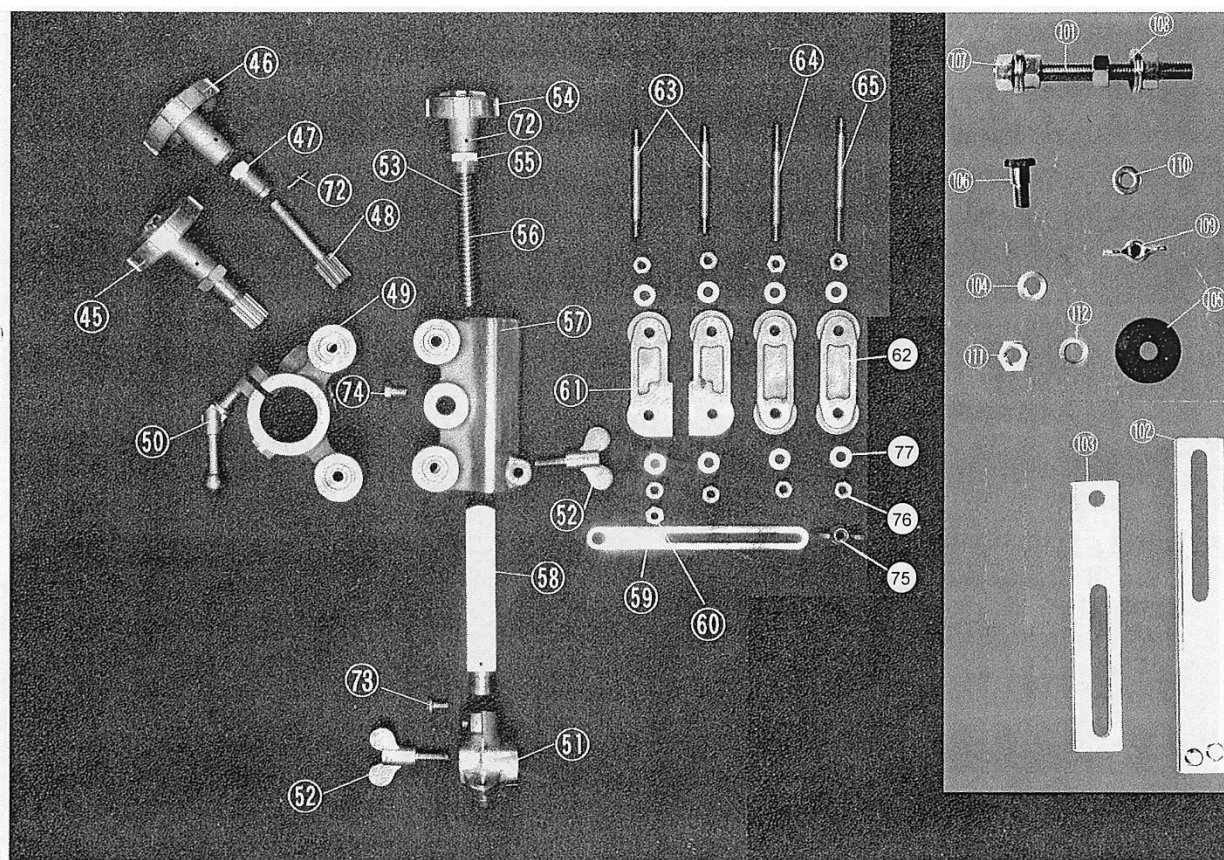

ITEM No.	PART NAME	Qty	STOCK No.	REMARKS
45	Cross feed handle assembly	1	60030316	
46	Handle	1	60030317	
47	Pinion metal	1	60030318	
48	Pinion	1	60030319	
49	Cross feed table holder	1	60030329	
50	Crank handle	1	60030313	
51	Torch holder bracket	1	60030391	
52	Wing bolt	2	60030392	
53	Up/down handle assembly	1	60030357	
54	Handle	1	60030223	
55	Screw metal	1	60030358	
56	Screw	1	60030359	
57	Up/down holder assembly	1	60030360	
58	Slide bar	1	60030361	
59	Fixing plate	1	60030331	
60	Hex nut	1	60030332	
61	Ling arm(A)	2	60030333	
62	Ling arm(B)	2	60030334	
63	Bearing shaft(A)	2	60030335	
64	Bearing shaft(B)	1	60030336	
65	Bearing shaft(C)	1	60030337	

ITEM No.	PART NAME	Qty	STOCK No.	REMARKS
72	Spring pin	2	6B022516	PR-2.5x16
73	Screw	1	6C520614	SP-6x14
74	Hex bolt	1	6C010612	BH-6x12
75	Wing nut	1	6D090060	NB-6
76	Hex nut	8	6D010060	NH-6
77	Washer	8	6D500060	WF-6
101	Setting shaft	1	60032341	
102	Plate A	1	60032342	
103	Plate B	1	60032345	
104	Collar	1	60032346	
105	Guide roller	1	60030342	
106	Guide roller shaft	1	60030343	
107	Hex nut	4	6D010120	NH-12
108	Washer	4	6D500120	WF-12
109	Wing nut	1	6D090080	NB-8
110	Washer	1	6D500080	WF-8
111	Hex nut	1	6D010100	NH-10
112	Spring washer	1	6D510100	WS-10

IK-12max3 TORCH SP-300

Date of issue: Apr.2019

KOIKE SANZO KOGYO CO., LTD